



# Columbus

Designed performance packaging solutions for high value component protection.



## ASTON MARTIN

### Snapshot

Who are Aston Martin: An iconic marque of unrivalled heritage.

How Columbus helped: Packaging solution for storage and transportation of Head, Tail and Deck Light Units through all stages of manufacture and transport.

Solution: Agile | Bespoke | Competitive costing

### Summary

Received design brief for:

- Closed loop returnable system.
- Each container less than 7kg in weight when loaded with light unit.
- Packaging to be recyclable at the end of its life.

### Solution:

- Made from light weight and durable Expanded Polystyrene (EPS).
- Each tray designed to hold left and right hand light units.
- Material meets the anti-static requirements.
- Each tray has a recess on the top face and the bottom face to allow for easy and safe stacking.
- Drain holes provided in all trays to allow for easy cleaning.
- Lids are available for all containers.
- Label recess provided on all containers.

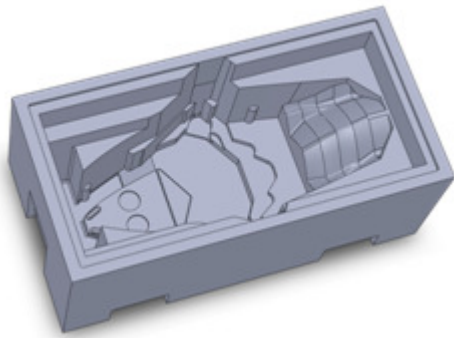

**External Tray Size 800 x 400 x 324 mm**

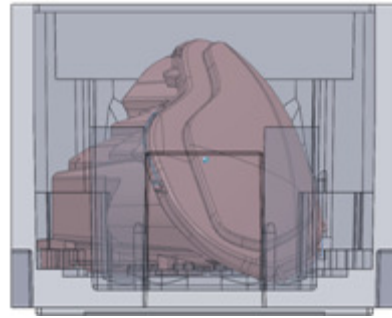

**Packaging protects lens face from abrasion damage in transit.**

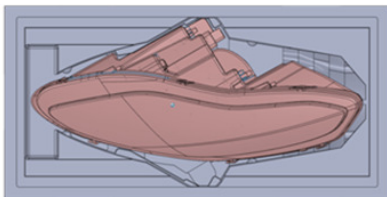

**Box designed to hold right or left handed unit.**

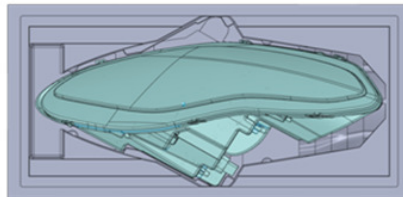

**Box designed to hold right or left handed unit.**

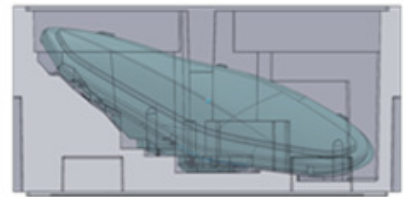

**Box designed for easy loading and unloading.**



**Designed to fit either left or right rear lights.**

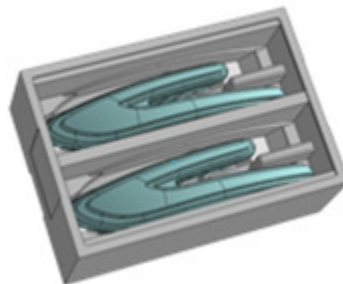

**Right Handed Rear Lights.**

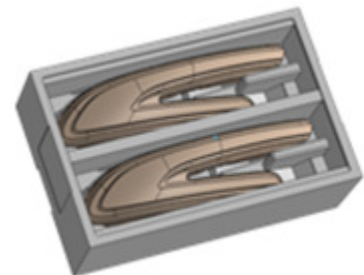

**Right Handed Rear Lights.**

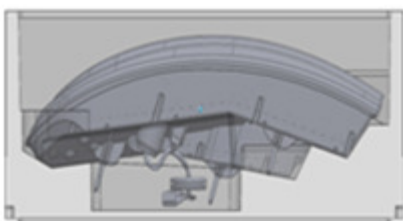

**Lens face protected.**

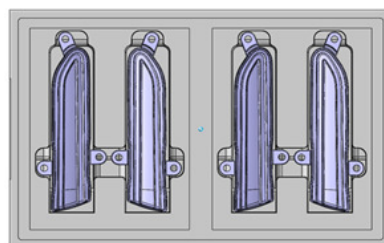

**Container design with 4 cavities for left or right unit.**

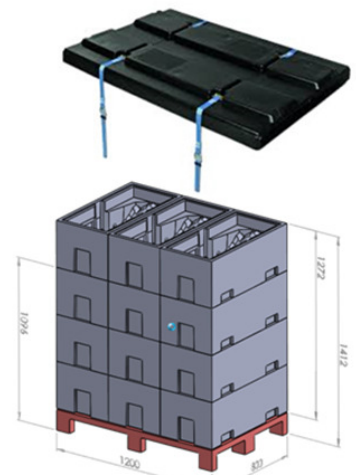

**Designed to fit on a standard Euro pallet.**